

Din Rail Bracket Sunpower

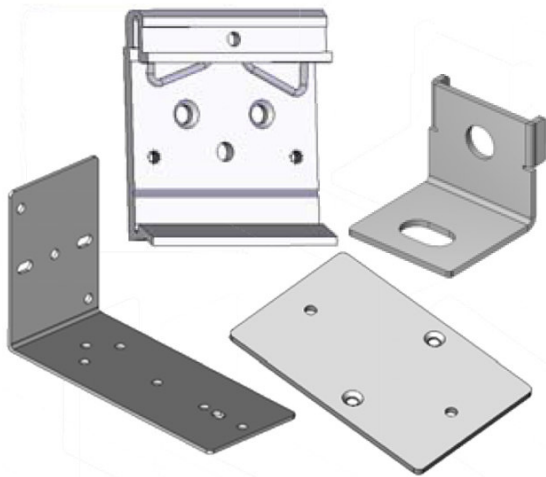

- Befestigungsmaterial für Schaltnetzteile: DIN-Schienenschnappbefestigung, Befestigungswinkel und Befestigungsplatte
- Direkt auf das Gehäuse schraubbar
- Aufschnappbar auf DIN-Schiene
- Diverse Befestigungsmöglichkeiten

Artikelnummer	Typ	Beschreibung
2 080 901	60-475-076R / DB-01	Schnappbefestigung
2 080 903	60-475-079R / LB-01	Befestigungswinkel (L)
2 080 904	60-475-080R / LB-02	Befestigungswinkel (L)
2 080 905	60-475-155R / P-01	Befestigungsplatte
2 080 906	60-475-158R / P-03	Befestigungsplatte
2 080 902	60-475-159R / DB-05	Schnappbefestigung
2 080 900	60-475-160R / DB-04	Schnappbefestigung
2 080 899	60-475-109R / P-02	Befestigungsplatte
2 080 909	60-475-213R / DB-02	Schnappbefestigung
2 080 907	60-475-186R / FB-02	Befestigungswinkel
2 080 908	60-475-212R / DB-03	Schnappbefestigung
2 080 898	60-477-003R / FB-01	Befestigungswinkel
2 080 897	60-477-004R / FB-03	Befestigungswinkel

DB-01

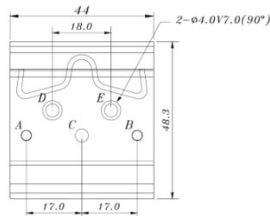

DB-02

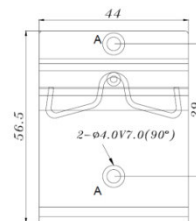
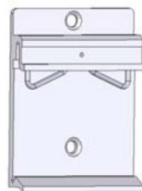

DB-03

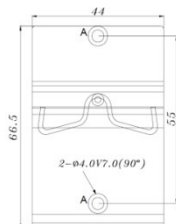
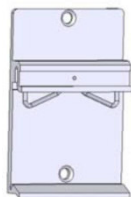

DB-04

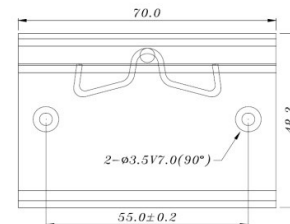
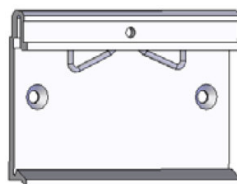

Kategorie: 5B



DB-05

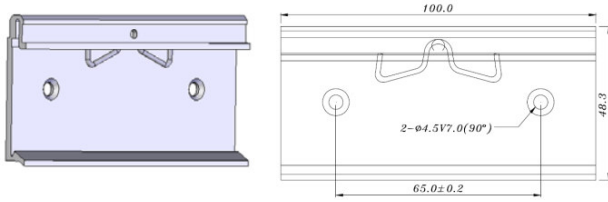

LB-01

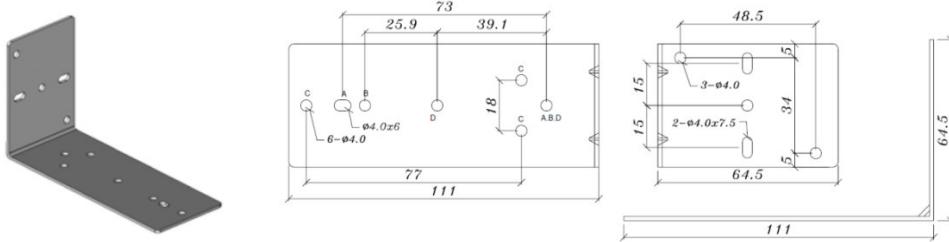

LB-02

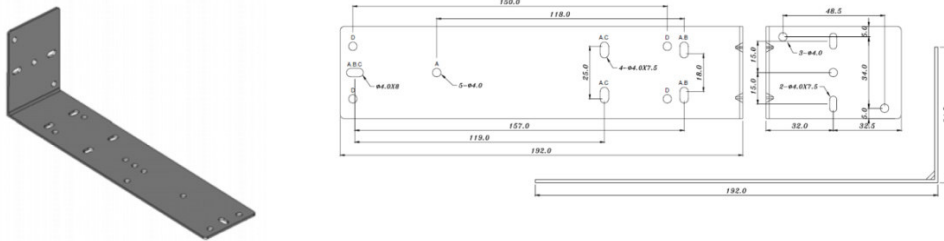

P-01

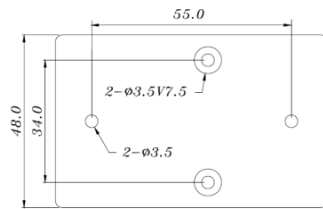
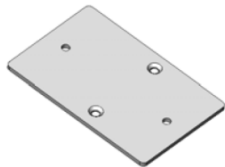

P-02

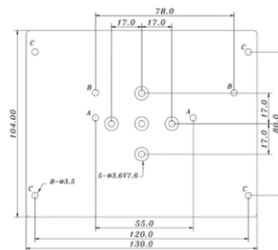
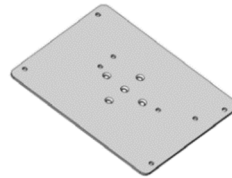

P-03

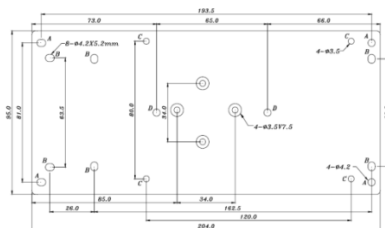

FB-01

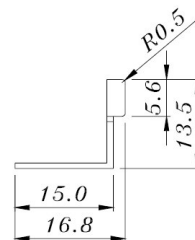
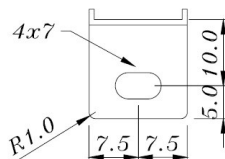
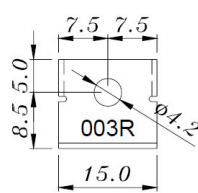

FB-02

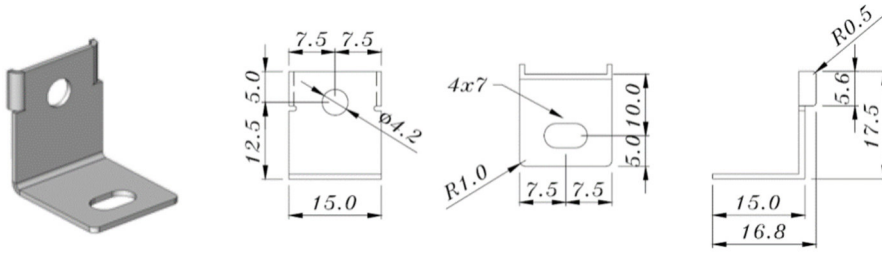

FB-03

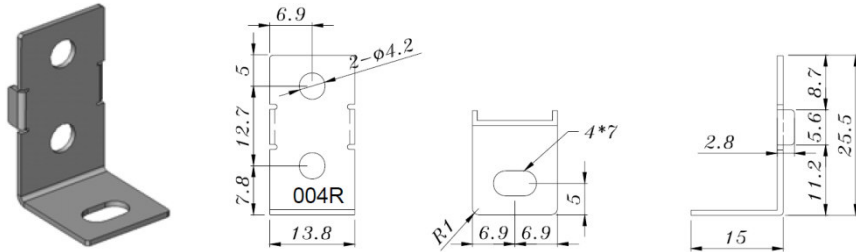

Montage

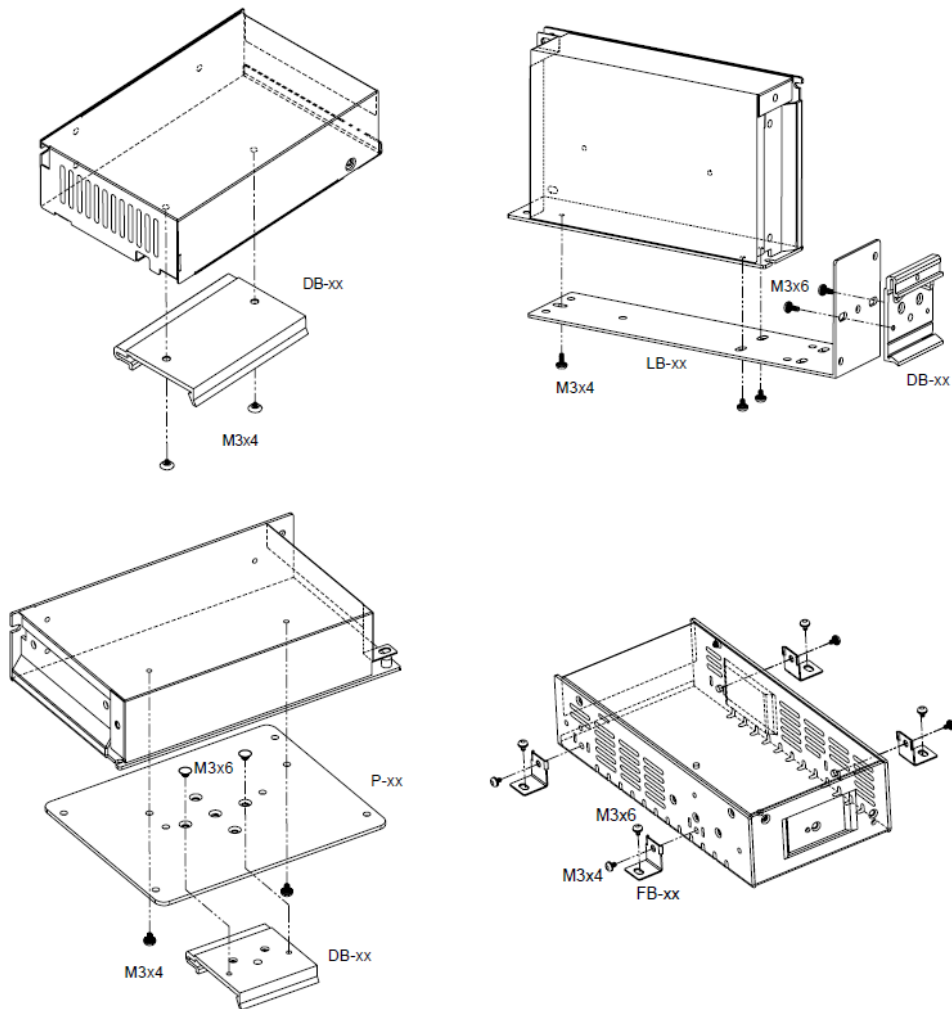

Verwendung

	DB-01	DB-02	DB-03	DB-04	DB-05	DB-01 + LB-01	DB-01 + LB-02	FB-01	FB-02	FB-03	DB-01 + P-01	DB-01 + P-02	DB-01 + P-03
SPE-150					▲				○				
SPE-200 / 320 / 500									○				
SPS-G018 / 018		▲				○							
SPS-G025 / 025			▲	▲	○	○					▲		
SPS-035 / G050 / S060 SDS-035 / SDS-050L/M SDN-060			▲	▲		○					▲	▲	
SPB-100 / SPS-N075 / N100 SDS-075L/M	○					○							
SPS-N110 / N150 SPS-N080 / N120 SDS-060 / SDS-100L/M SDN-100	○						○					▲	
SDN-150	○						○					▲	
SPS-225P / 360P SDN-200 / 350	○				▲		○		○				▲
SPS-750P / 960P									○				

○ Die Befestigung befindet sich an der Seite des Metallgehäuses

▲ Die Befestigung befindet sich an der Unterseite des Metallgehäuses